



GL-1500 Trailer Wire Harness PARTS 090-142T INSTALLATION INSTRUCTIONS

To install trailer wire harness kit you will need to remove the following parts: Follow service manual instructions.

Trunk lower pan: (see illustration and use service manual)

Seat: (if optional accessory wire is to be used)

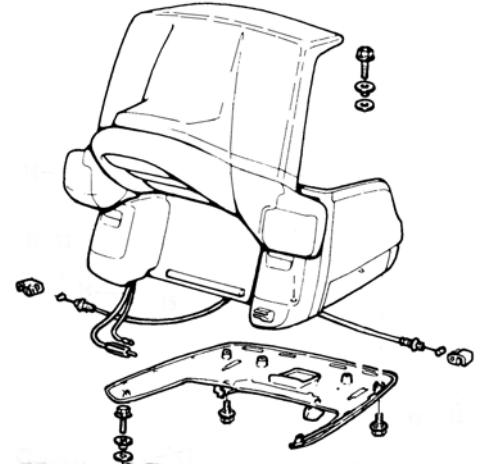
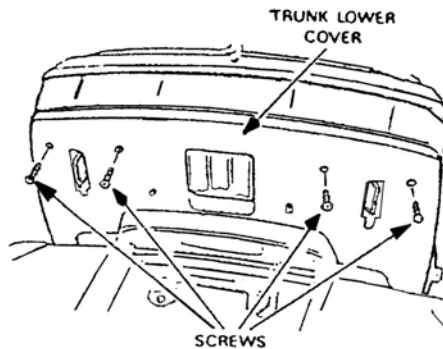

After removing trunk pan, run a stiff piece of wire from the bottom of the left saddlebag frame behind the rear tire up until it comes out under the trunk. Then hook open end of wire harness to fish wire and tape with electrical tape. Pull the harness back down to the bottom of the saddlebag frame. Route the long part of harness wire around the back of the license plate light to the right side 6-pin vertical connector just in front of tail light assembly. Unplug the stock connector and plug wire harness in between the stock plugs. Do the same for the left side with the short side of the Y on the harness.

Now pull the slack down from the bottom of the harness and tuck all of the wires under the frames tubes so that the pan can be reinstalled without any problems.

You can now hook up the loose ends of the harness to any style connector to match your trailer connector using the following color codes:

GREEN - GROUND
YELLOW- BRAKE
BROWN- TAIL
ORANGE- LEFT TURN
BLUE- RIGHT TURN

NOTE: THESE COLOR CODES MATCH STOCK WIRING COLORS ON GL-1500

NOTE: WHITE wire can be attached to an accessory terminal on the fuse block for interior light, etc.